

# EVENTSPACE

AT SALISBURY HOUSE



**WORKSPACE**<sup>®</sup>

EVENTSPACE



AT SALISBURY HOUSE

## EVENTSPACE AT SALISBURY HOUSE

Located in a jewel among office buildings in the heart of the City, our Eventspace at Salisbury House offers elegant Grade II listed charm to put a touch of splendour to any event.

Salisbury House has been a feature of the City since 1898, when it became one of London's first purpose-built office buildings. Formerly home to gold and diamond traders and once used as a hospital, echoes of the building's former past are everywhere.

We've preserved the historic grandeur of this magnificent building while giving it a chic, elegant facelift, with fully integrated connectivity to ensure the success of your event.



**Our Eventspace at Salisbury House offers a grand, elegant solution for your event, providing a historic backdrop in the heart of the City. With high-speed connectivity and top of the line tech to ensure a memorable event.**

We've designed our Eventspace with total flexibility in mind, which means it can be adapted to suit your needs, from a theatre, to a boardroom, or even a banquet hall. Whatever your function, we can make it work.

Accessible via its own dedicated and decadently finished entrance on London Wall, every aspect of our Eventspace is designed to create a lasting impression among visitors.

The lounge area is central to the layout of the space, providing an ideal communal reception area, a meet and greet or networking lounge for your guests, or somewhere to serve lunch and refreshments.

A grand, elegant solution for your event

With its huge screens, our elegant and spacious main conference room Marquise is perfect for seminars, workshops or can double up as a private dining space. An additional room, Trillion, is separated off from the main conference room with a partition wall. This is ideal as a classroom, theatre or training space, or can be used to expand Marquise to host up to 160 people. Easily moveable furniture offers maximum flexibility with your layout.

Our smaller meeting rooms offer a more intimate space while retaining generous proportions. They can be booked separately, or included in our main Eventspace booking for larger functions. Designed for flexibility and functionality, they are ideal for team meetings, presentations and lectures.

Why not also book a smaller meeting room to compliment the larger conference spaces?

# MARQUISE & TRILLION COMBINED

We've created our Eventspace with flexibility in mind, enabling us to accommodate functions of all sizes. For larger events, we can expand the floor area, while our furniture can be easily rearranged to create the ideal environment for your needs. Floorspaces can also be adapted for catering and informal gatherings.

Adjoining rooms, Trillion and Marquise, can be opened to form one large room or be separated into two, depending on your group's preferences. From theatre to boardroom layouts, banquet dinners to classroom, we can create the perfect seating arrangement for your function.

## Equipment:

Cameras for video conferencing	2
110 inch LCD screens	3
Handheld microphones	2
Lapel microphones	2
BOSE speakers	
Air-conditioning	
Lectern	

**SIZE: 1,531 SQ FT**

**CAPACITY:**



**THEATRE  
160**



**BANQUET  
80**



**CABARET  
80**





## MARQUISE

The largest conference room in our Eventspace is designed to be swiftly adapted to your requirements, with easily moveable furniture and additional areas that can be partitioned off or opened out to enlarge the floor area. This provides exceptional flexibility for your event planning and can accommodate a wide range of functions.

Technology is fully integrated throughout this generous, elegant space, allowing your guests to enjoy high speed wi-fi and providing the opportunity for video conferencing and presentations on the huge screen with total confidence.

Dining is optional, and our lounge area can be used for serving food and refreshments.

A large skylight allows natural light to flood in and enhance the space.

**SIZE: 1,076 SQFT**

**CAPACITY:**

 THEATRE  
110

 BANQUET  
60

 CABARET  
50

**Equipment:**

**Cameras for video conferencing** 2

**110 inch LCD screens** 2

**Handheld microphones** 1

**Lapel microphones** 1

**BOSE speakers**

**Air-conditioning**

**Lectern**





## TRILLION

**SIZE: 455 SQFT**  
**CAPACITY:**

 THEATRE  
40

 BANQUET  
20

 CABARET  
25

 BOARDROOM  
22

 CLASSROOM  
16

Our smaller conference and meeting room is separated from the main area with a partition wall. This space is entirely flexible and can be quickly integrated into the main area to allow more room for larger functions.

The room is also fully equipped with wi-fi and its own large screen, providing an ideal solution for video conferencing, presentations, training workshops or meetings.

A spectacular rooflight runs the length of Trillion, allowing natural light to flood in and enhancing the sense of space.

### Equipment:

<b>Cameras for video conferencing</b>	<b>2</b>
<b>110 inch LCD screens</b>	<b>1</b>
<b>Handheld microphones</b>	<b>1</b>
<b>Lapel microphones</b>	<b>1</b>
<b>BOSE speakers</b>	
<b>Air-conditioning</b>	
<b>Lectern</b>	

MARQUISE & TRILLION  
LAYOUT OPTIONS

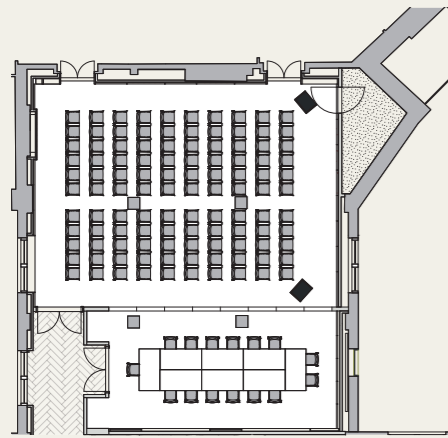

THEATRE 110  
BOARDROOM 22

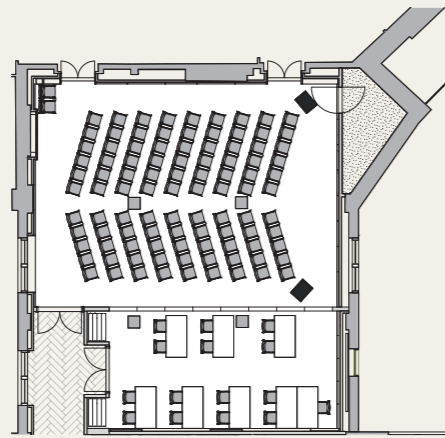

CHEVRON 99  
CLASSROOM 16

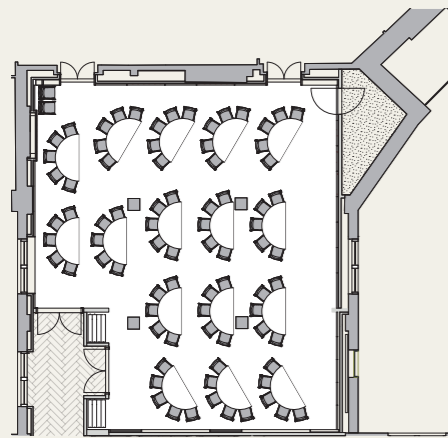

CABARET 80

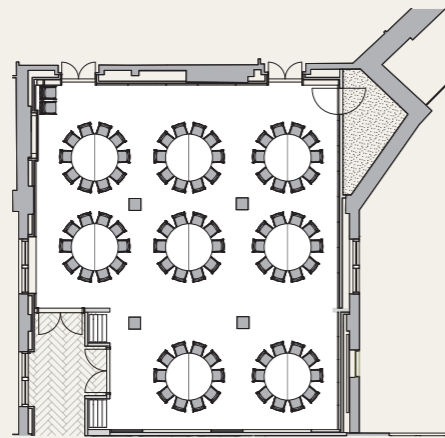

BANQUET 80

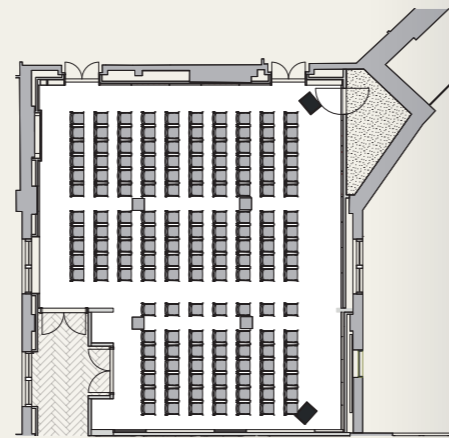

THEATRE 160

EVENTSPACE  
AT SALISBURY HOUSE

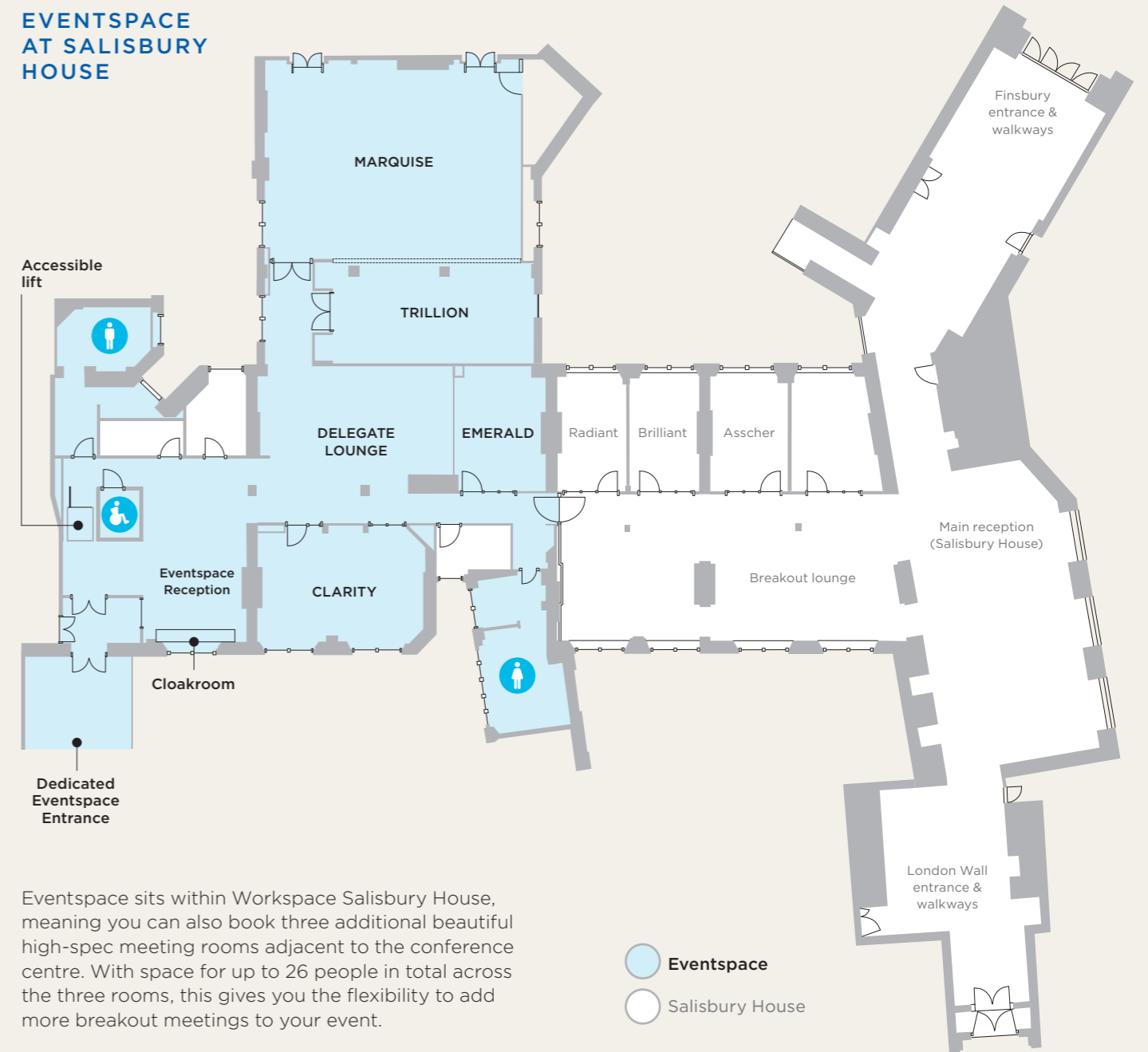

Eventspace sits within Workspace Salisbury House, meaning you can also book three additional beautiful high-spec meeting rooms adjacent to the conference centre. With space for up to 26 people in total across the three rooms, this gives you the flexibility to add more breakout meetings to your event.

- Eventspace
- Salisbury House

## BOARDROOMS AND MEETING ROOMS

Why not also book a smaller meeting room to compliment the larger conference spaces?

Our meeting rooms offer an elegant, charming space for up to 16 people and are fully equipped with high-speed wi-fi and large screens for video conferencing. Bookable by the hour and available with a variety of add-on options according to your requirements, they offer an elegant, intimate location for your next meeting.

Created with your comfort in mind, every room features chairs you could sit in for hours and well-curated furnishings and calming colour schemes that immediately put you and your colleagues at ease.

Every room is individually styled to an extremely high level, providing a sense of ambience reminiscent of a boutique hotel or member's club, with soft lighting, plush carpets and in some externally-facing rooms, plenty of natural light.

Every meeting room is accessible from the communal area, with crittall glass feature walls providing a sound-proof partition while retaining a sense of space.

Full connectivity and options that include food and refreshments also mean we're able to meet most requests. Just speak to a member of the team.

An elegant,  
intimate location  
for your  
next meeting



CLARITY	UP TO 16
EMERALD	UP TO 12
ASSCHER	UP TO 10
BRILLIANT	UP TO 8
RADIANT	UP TO 8







## CATERING

Feeling peckish? We have food packages to suit events of any size, from light refreshments for smaller meetings, day delegate packages, to full catering options for large events.

Just choose from one of our sample menus, or for more bespoke lunch and canape requirements, our caterers can create bespoke menus, the perfect choice for your day.

Our caterers pride themselves on using only the finest, locally-sourced produce to create mouth-watering menus that your guests will love.



### Sample menu

#### DAY DELEGATE PACKAGE

##### Breakfast

Selection of Mini Pastries  
 Selection of Muffins  
 Coconut Yoghurt with Raspberry Compote, Goji & Coconut Granola  
 Quinoa Bircher with Caramelised Banana & Peanut Praline  
 Turmeric Soy Yoghurt with Spiced Apple Jam & Crunchy Almonds

##### Mid Morning & Afternoon Break

Rye Chocolate Crackle Cookie  
 Vegan Doughnuts  
 Date & Coconut Energy Ball  
 Oat & Raisin Cookies  
 Gluten Free Cocoa, Date & Nut Power Balls  
 Fresh Fruit Basket

##### Lunch

Oven Roasted Salmon  
 Meaty Sandwich Selection  
 Vegan Sandwich Selection  
 Gluten Free Sandwich Selection  
 British Picnic Selection  
 Cracked Falafel, Spinach, Houmous & Vegan Feta Salad  
 Torn Buffalo Mozzarella, Pickled Chilli & Crushed Avocado Salad  
 Hand Fried Potato Crisps  
 Orange & Polenta Bundt Cake  
 Vegan Jaffa Sponge  
 Seasonal Sliced Fruit Platter

#### CANAPÉS

##### Meat & Fish

Rolled Hot Smoked Brisket Beef  
 Salame di Finocchiona  
 Chicken Satay Skewer  
 Gin Cured Salmon Loin  
 Paprika Prawn Cocktail

##### Vegetarian

Dill & Chive Rolled Boilie Goats Cheese  
 Almond, Harissa and Saffron Cake  
 Caraway and Cumin Shortbread

##### Vegan

Harissa Hummus  
 Japanese Spiced Tofu

##### Sweet

Orange Cardamom Posset  
 Raw Cacao, Medjool Date & Pecan Truffle





*As owner of historic properties, we play a key role in the employment-led regeneration of areas all over London*



*Ben Fogle recently hosted one of our London's Brightest Businesses panel sessions*

## SUSTAINABILITY

**Driving forward our Environmental, Social and Governance agenda is a top priority for Workspace. As a long-term owner of historic properties across the city, we play a key role in the employment-led regeneration of areas all over London. We take seriously our responsibility to positively impact local communities, while reducing our impact on the environment.**

Climate change mitigation is a cornerstone of our ESG strategy. In recent years, we have made significant progress on decreasing greenhouse house emissions and we are now taking our climate ambitions one step further, with our commitment to be a net zero carbon business by 2030.

Workspace has played a key role in the employment-led regeneration of areas across London for over 30 years now, and building communities and improving our neighbourhoods over the long term is an important part of our business strategy.

As well as bringing employment into emerging areas as we launch new or refurbished properties, we also go out into the local communities to offer employment-focused support to disadvantaged young people, such as careers workshops and work experience.

Supporting our employees, customers and suppliers is a key priority, and is more important than ever during uncertain times. From ensuring our centres remain open and safe, to hosting wellbeing webinars for employees and customers and committing to prompt payments for suppliers, we work hard to look after our people.

## HOW TO GET HERE

You'll find Eventspace at Salisbury House in Moorgate, at the heart of the City, London's bustling financial district. The building curves around the corner of Finsbury Circus and overlooks part of the historic London Wall. Access to the Eventspace is through its own dedicated entrance on London Wall.

We're a stone's throw from Moorgate tube station with access to the Elizabeth Line and only a few minutes walk from Liverpool Street Station.

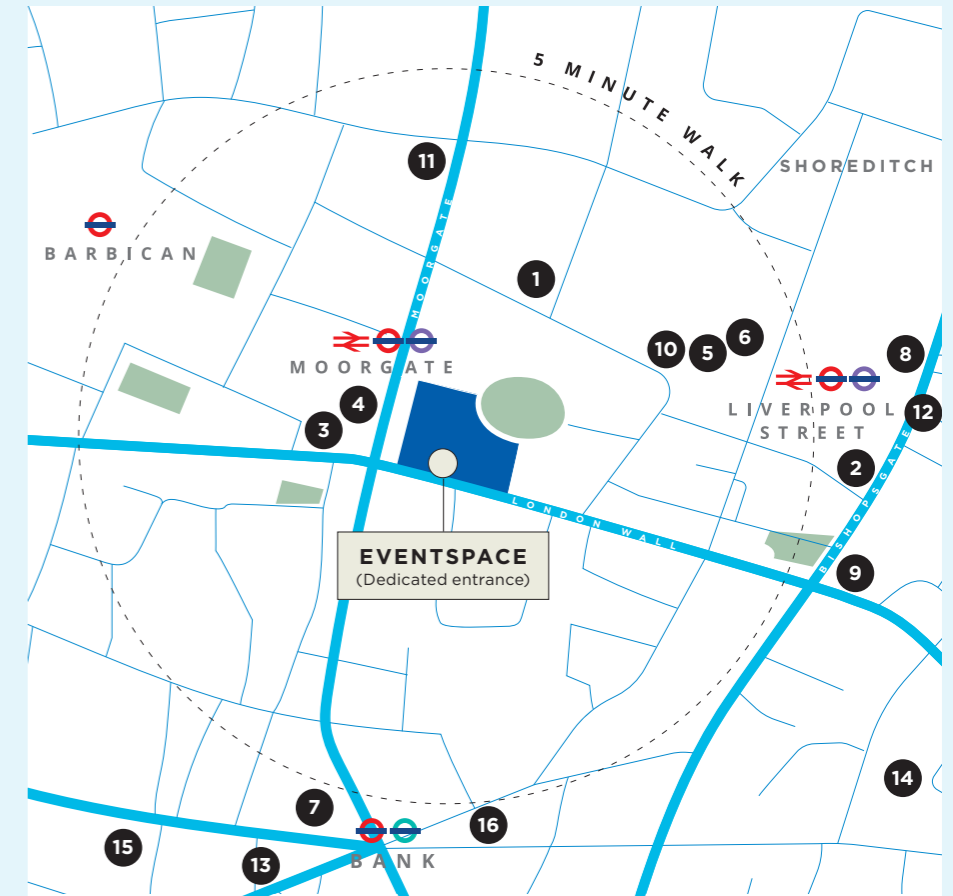

### In the area

For networking and when you have time to explore, there are endless opportunities to socialise, shop and take in some of London's most historic buildings.

- |                            |                                |
|----------------------------|--------------------------------|
| <b>1</b> South Place Hotel | <b>9</b> Sushisamba            |
| <b>2</b> Andaz Hotel       | <b>10</b> 1 Rebel Broadgate    |
| <b>3</b> Fox Wine Bar      | <b>11</b> All Bar One Moorgate |
| <b>4</b> The Globe         | <b>12</b> Spitalfields Market  |
| <b>5</b> Broadgate Circle  | <b>13</b> Puttshack Bank       |
| <b>6</b> The Botanist      | <b>14</b> Swingers Crazy Golf  |
| <b>7</b> The Ned           | <b>15</b> One New Change       |
| <b>8</b> Eataly            | <b>16</b> The Royal Exchange   |

## GET IN TOUCH

Booking our Eventspace at Salisbury House for your function couldn't be easier. Just click through on the link below to leave your contact details, and a member of our team will be in touch right away to discuss your requirements and find a suitable date.

[CLICK HERE TO  
GET IN TOUCH](#)

**For further information contact:**

**[Eventspace@workspace.co.uk](mailto:Eventspace@workspace.co.uk)**

**0203 883 6327**

**[workspace.co.uk/eventspace](https://workspace.co.uk/eventspace)**

Eventspace at Salisbury House  
114 London Wall  
EC2M 5QD

Owned and managed by Workspace

